

Location Map



- Easy access via major highways – CTE, SLE
- Short bus ride to Ang Mo Kio station
- Eating houses, Sheng Siong supermarket and air-conditioned food court are within walking distance
- Close proximity to Serangoon Gardens, Hougang and Ang Mo Kio Town Centres with a wide variety of amenities such as food centres (e.g. Chomp Chomp Food Centre) and shops

maple^{tree}
industrial
Your Preferred Real Estate Partner

Leasing Enquiries
☎ 6377 8000
✉ industrial@mapletree.com.sg
💻 www.mapletreeindustrialtrust.com

Mapletree Industrial Trust
10 Pasir Panjang Road, #13-01, Mapletree Business City, Singapore 117438

Disclaimer: While every reasonable care has been taken in preparing this factsheet, neither Mapletree Industrial nor their appointed marketing agents can be held responsible for any inaccuracy or changes and any loss or damage arising therefrom. All information and specifications are subject to changes as may be approved or required by the relevant authorities and shall not form part of an offer or contract. All interested parties should satisfy themselves by inspection and enquiry as to the accuracy of the particulars which are believed to be correct but are not regarded as statements or representations of fact.

6 Serangoon North

6 Serangoon North Avenue 5 Singapore 554910

General Information

Building Type <ul style="list-style-type: none">• Hi-Tech Building	Zoning <ul style="list-style-type: none">• Business 1	Gross Floor Area <ul style="list-style-type: none">• 72,885 sqm	Net Lettable Area <ul style="list-style-type: none">• 54,455 sqm
Total Units <ul style="list-style-type: none">• 70	Unit Sizes <ul style="list-style-type: none">• 475 – 2,000 sqm	Parking Lots <ul style="list-style-type: none">• 317	Amenities <ul style="list-style-type: none">• Air-conditioned canteen on the 6th floor• Childcare centre

Technical Specifications

Floor Loading <ul style="list-style-type: none">• 10 – 20 KN/sqm	Floor to Beam Height <ul style="list-style-type: none">• Warehouse: 5.9 m• Factory Area: 4.3 m	Floor to Floor Height <ul style="list-style-type: none">• Warehouse: 6.5 m• Factory Area: 5.1 m	Passenger Lift <ul style="list-style-type: none">• 8 nos.
Power Supply Allocation <ul style="list-style-type: none">• Warehouse: 80 VA/sqm• Factory Area: 240 VA/sqm	Fire Protection <ul style="list-style-type: none">• Automatic electric fire alarm & sprinkler system• Smoke detectors• Dry riser hoses• Fire hydrant• Manual call points	Loading / Unloading <ul style="list-style-type: none">• 1st Floor: 32 Loading Bays & 14 Dock Levellers• 2nd Floor: 16 Loading Bays & 5 Dock Levellers	Cargo/Service Lift <ul style="list-style-type: none">• 12 nos. / 3,000 kg & 4,000 kg
Emergency Systems <ul style="list-style-type: none">• 1 no. / 800 KVA diesel generator (For building's essential systems such as lifts and fire protection system)	Building Management <ul style="list-style-type: none">• Building automation system is in place to control and monitor the building's air conditioning system	Lighting <ul style="list-style-type: none">• Motion sensors at toilets and staircases• Energy-efficient light fittings	Air-Conditioning <ul style="list-style-type: none">• Factory area, lift lobbies & corridors are served by central air-conditioning
Building Security <ul style="list-style-type: none">• 24h security with guards & CCTV			



Information as per most recent factsheet, except general writeup and accessibility - from website. If there are more information/specs to add on, kindly indicate here. Items highlighted in grey are not changeable for standardization among all MIT properties.

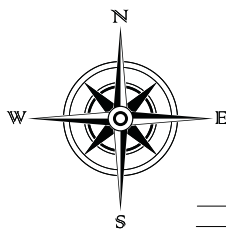

BLK 6 - LEVEL 1 TYPICAL FLOOR PLAN

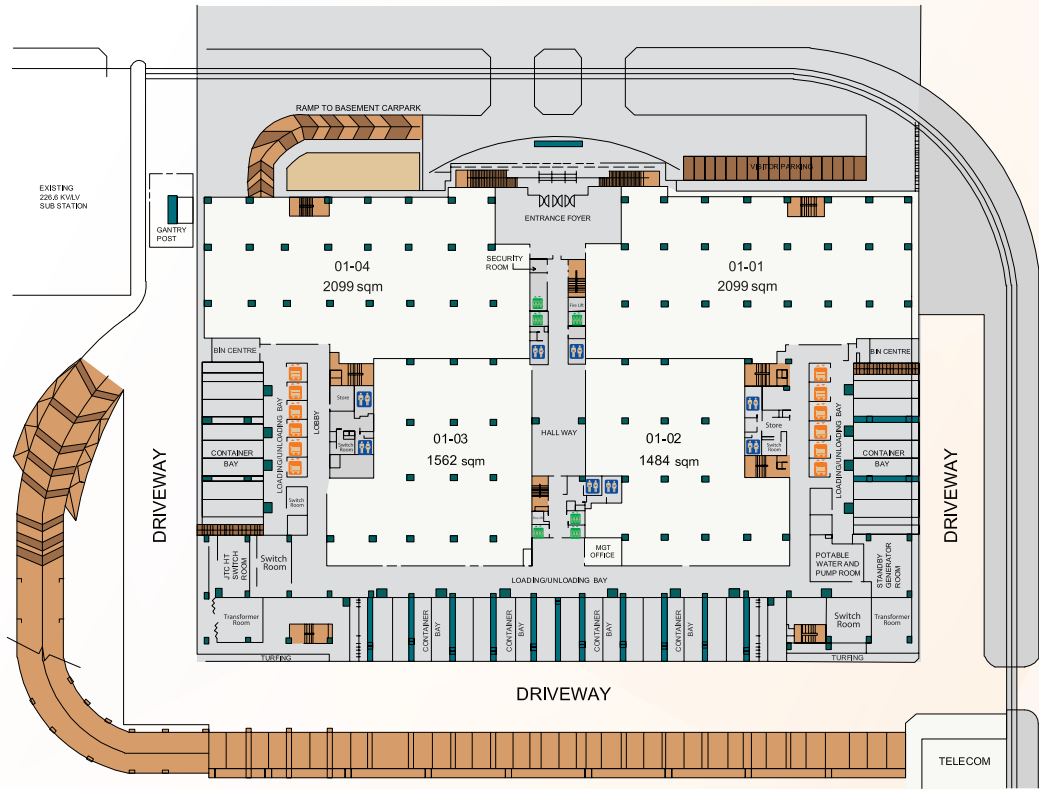

BLK 6 - LEVEL 3, 4 & 5 TYPICAL FLOOR PLAN

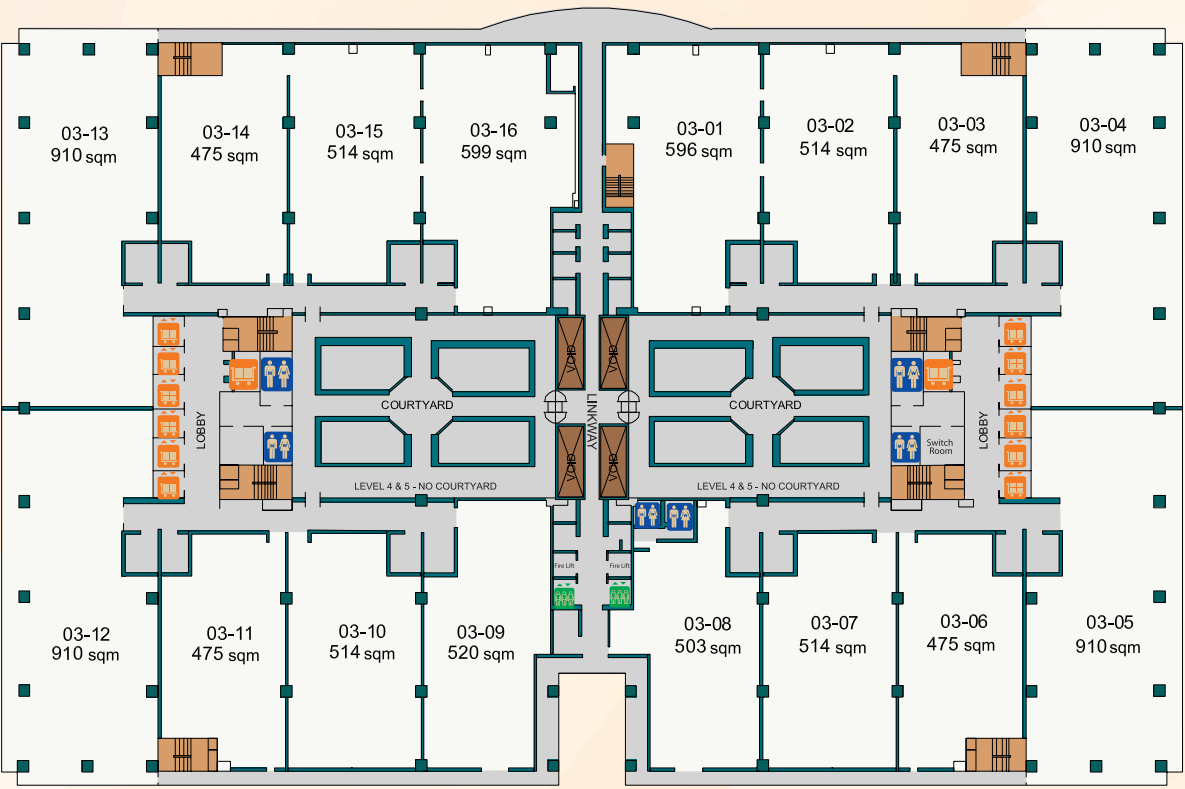

BLK 6 - LEVEL 2 TYPICAL FLOOR PLAN

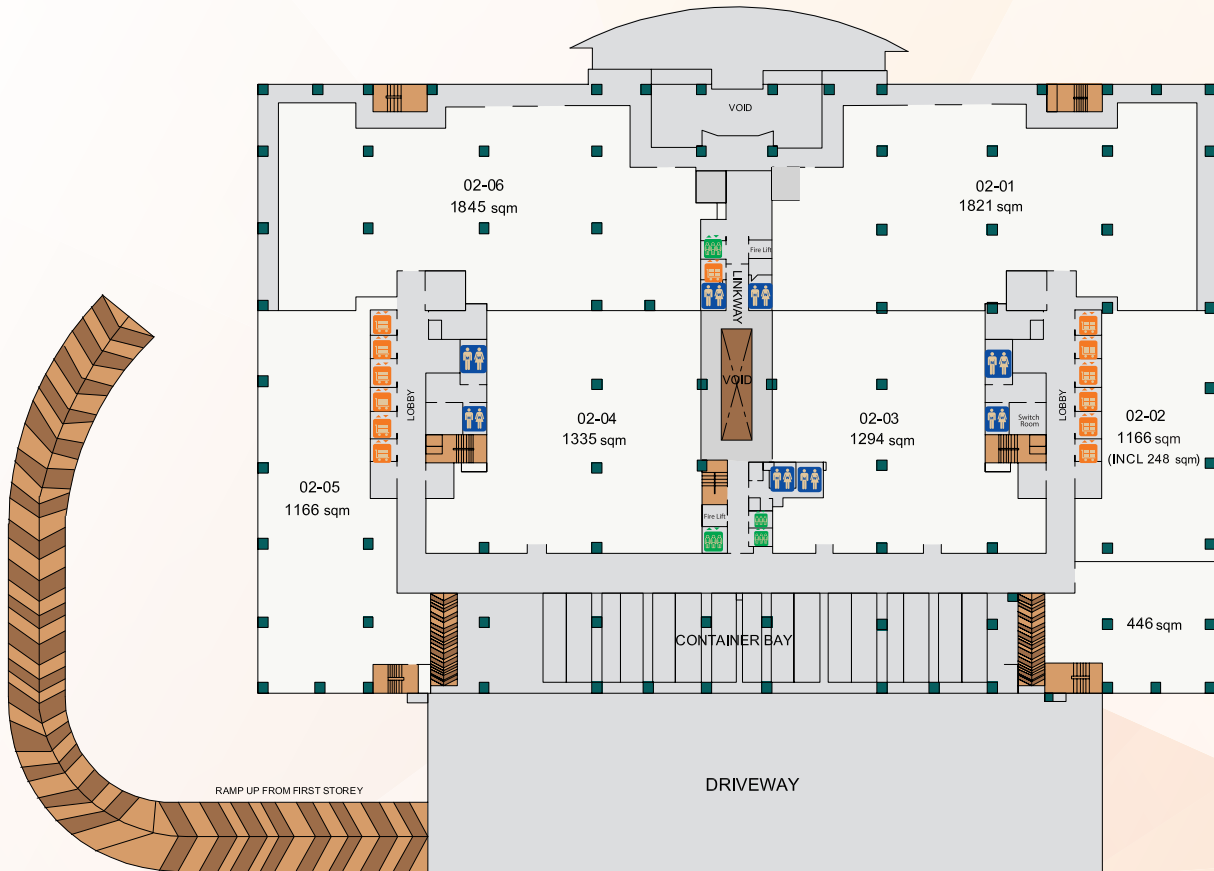

BLK 6 - LEVEL 6 TYPICAL FLOOR PLAN

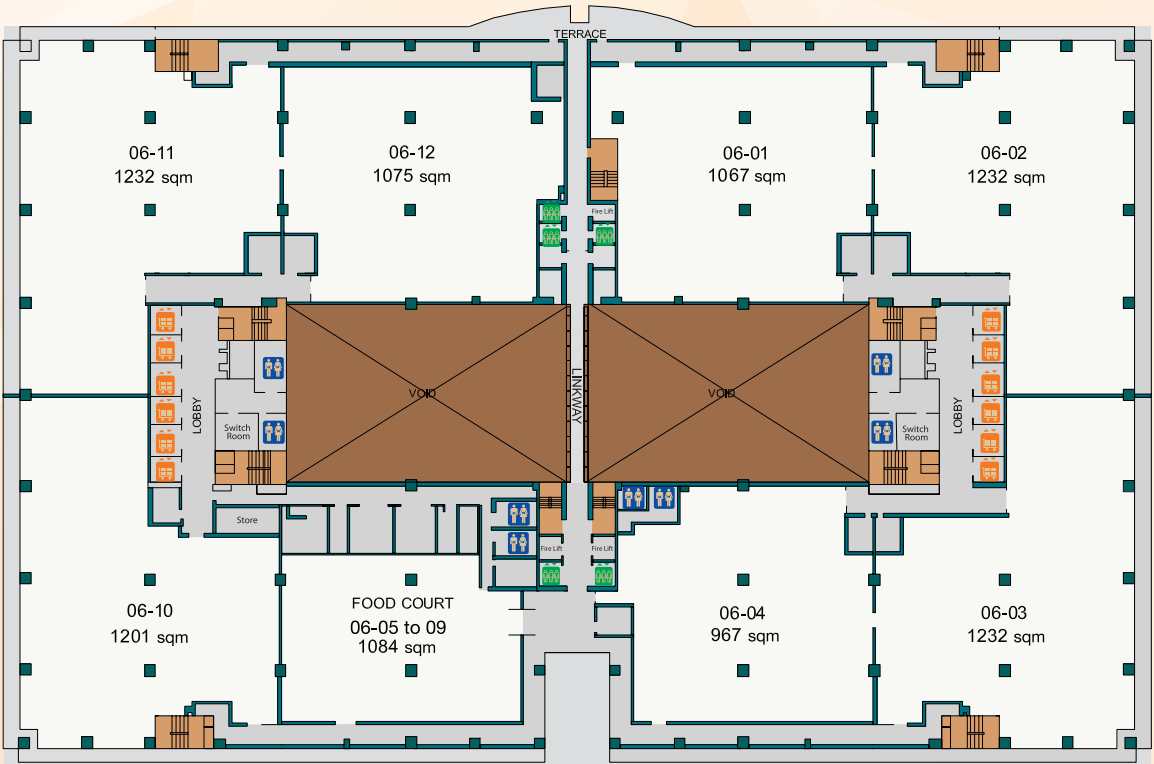

Toilet



Passenger Lift



Goods Lift